

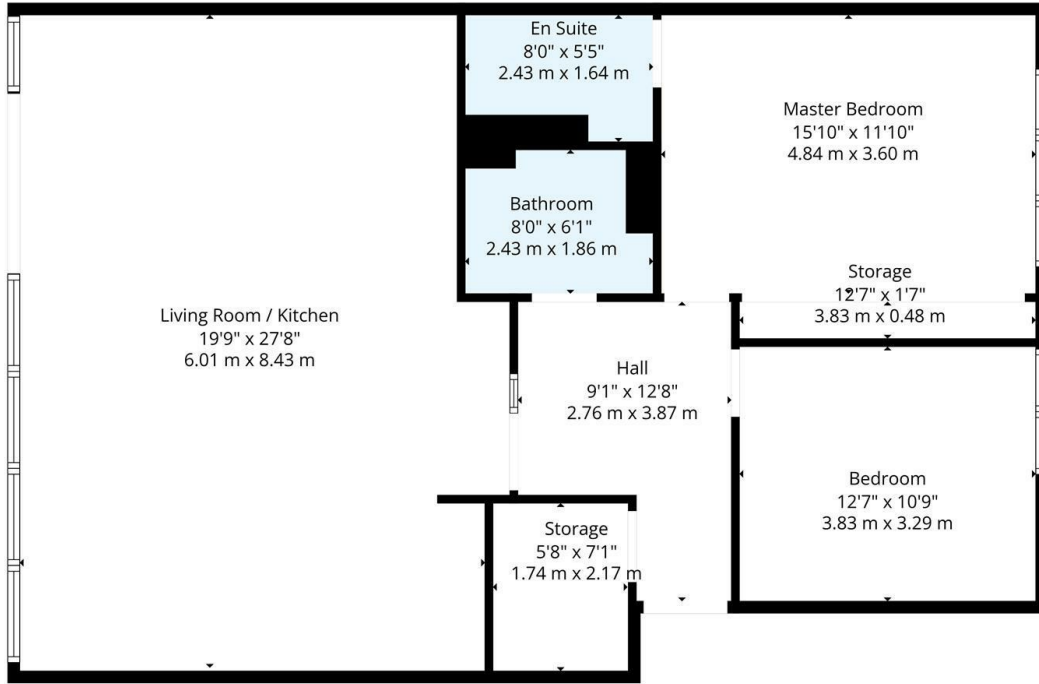

1/2, 110 Lancefield Quay, Glasgow, G3 8HR

Offers Over £195,000

- Modern 1st floor apartment in desirable Finnieston area of Glasgow
- Full height windows to lounge/dining area and sliding patio doors onto private balcony
- Spacious open plan lounge/Dining/Kitchen
- Two double bedrooms with Master featuring an en-suite shower room
- Secure private parking
- Gas Central Heating (Brand new Boiler) and Double Glazing
- Excellent storage throughout
- EER Band B



TOTAL: 1084 sq. ft, 101 m2
 1st floor: 1084 sq. ft, 101 m2
 EXCLUDED AREAS: STORAGE: 61 sq. ft, 6 m2, WALLS: 71 sq. ft, 6 m2
Floor Plan Created By Cubicasa App. Measurements Deemed Highly Reliable But Not Guaranteed.

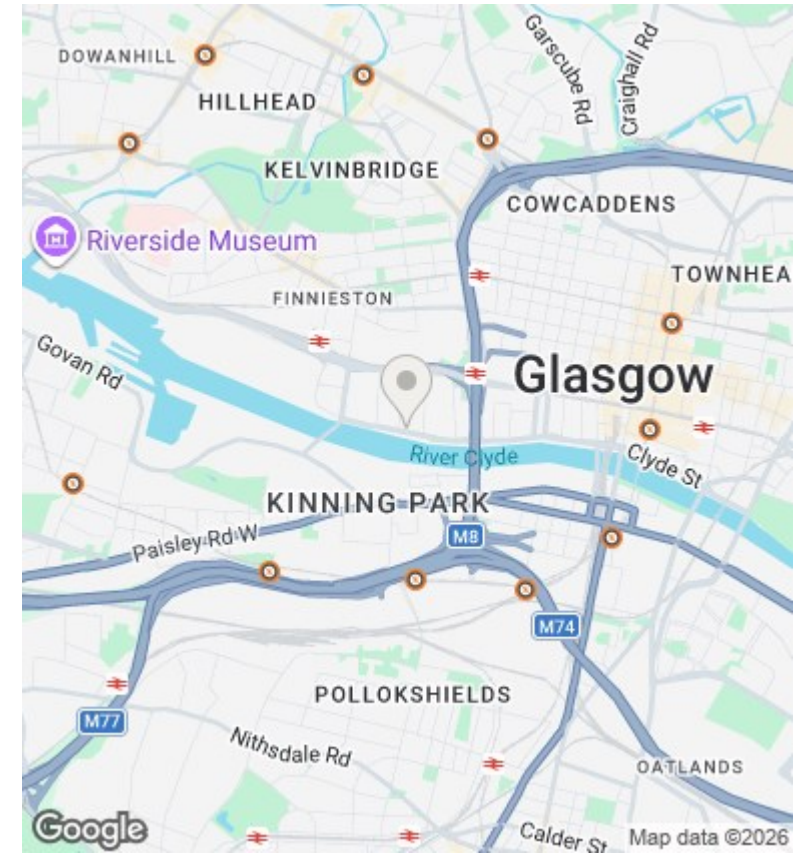

Directions

Viewings

Viewings by arrangement only. Call 01417262111 to make an appointment.

Council Tax Band

EPC Rating:

B

Energy Efficiency Rating		
	Current	Potential
Very energy efficient - lower running costs		
(92 plus) A		
(81-91) B	85	85
(69-80) C		
(55-68) D		
(39-54) E		
(21-38) F		
(1-20) G		
Not energy efficient - higher running costs		
Scotland	EU Directive 2002/91/EC	